

E T Claydon: Oak Tree

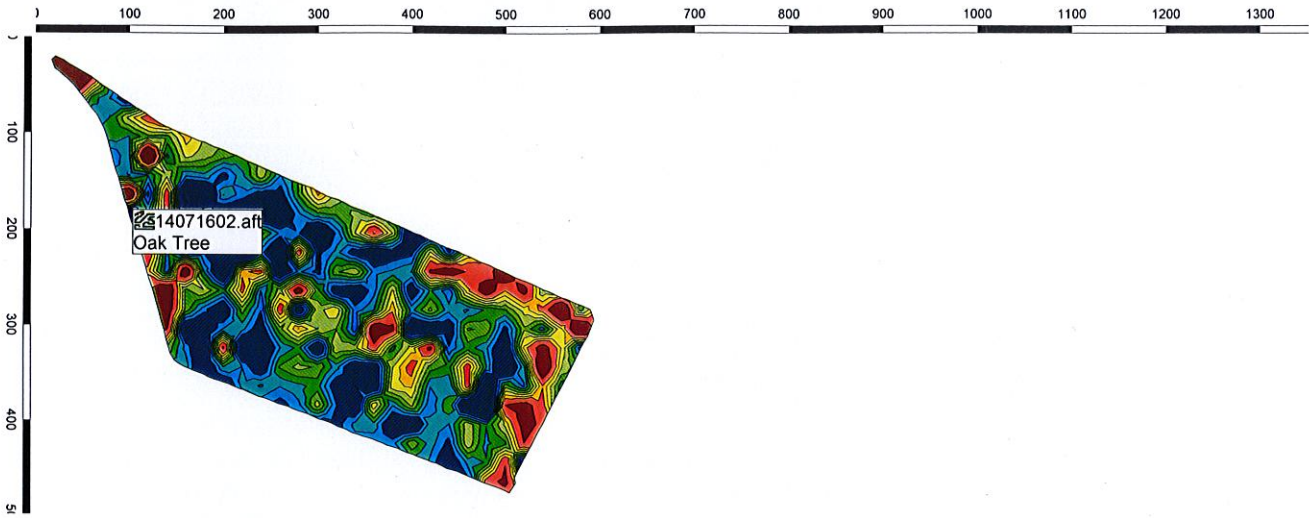

Raw Data '14071602.aft'

Customer: E T Claydon

Field: Oak Tree

GPS-Date: 16/07/2014 16:13:43

Legend 'W OSR' [t/ha]:

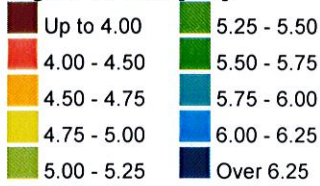

Totals From Job:

Area: 11.1100 ha

Total Quantity (W OSR): 48.594 t (4.37 t/ha)

Average Grain Moisture: 11.50 %

Totals From Map:

Field Boundary: 10.6807 ha

Average (W OSR): 5.52 t/ha

Total Quantity (W OSR): 59.00 t

Average for W OSR From Field Boundary:

48.594 t / 10.6807 ha = 4.55 t/ha

Histogram for W OSR:

